

Universal, oversized and receptacle mount installation:

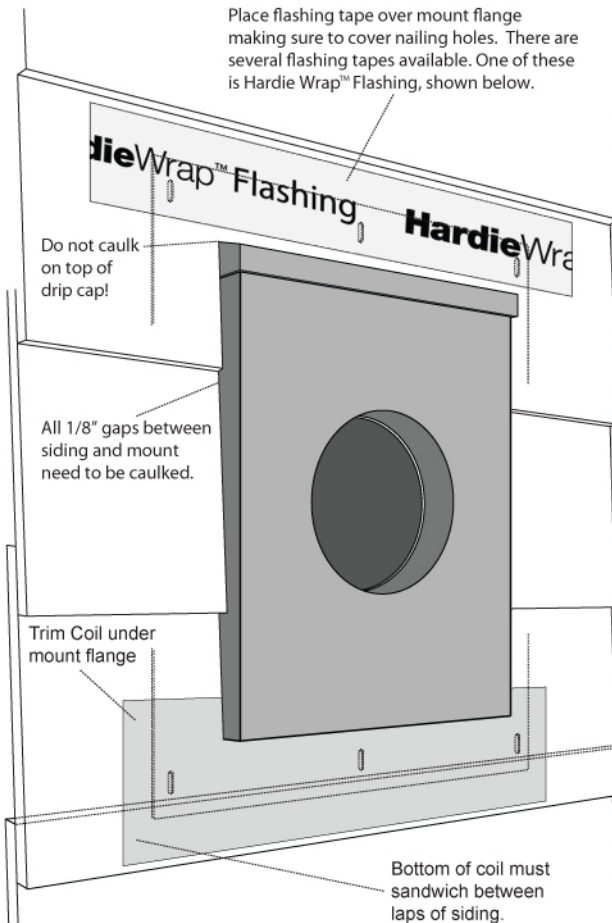

Step 1 - Place desired mount over the proper application needed. Align and level mount parallel with siding to be installed. Nail the top three and side two flange holes with 2 1/2" roofing nails. Make sure to leave the bottom three flange nailing holes un-nailed. Cut trim coil at least 2" wider than mount flange.

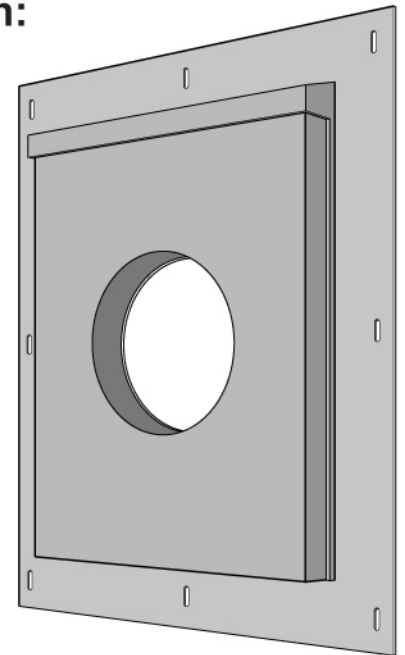

Step 2 - Slide trim coil under bottom part of plastic flange at least 2" above flange nailing holes. Position trim coil directly below and in between siding. Nail 2 1/2" roofing nails through the remaining bottom three nailing flange holes.

Materials needed:

- 2 1/2" roofing nails
- 2" brad nails
- OSI Quad caulk
- trim coil
- Hardie Wrap™ Flashing

Split mount installation:

Step 1 - Detach bottom half of block from plastic flange by placing finger through 1" hole and then pulling down and out until block is detached. Remove remaining glue pad from the face of the plastic flange.

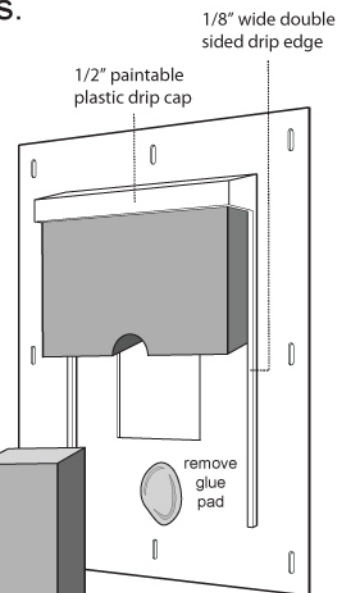

Penetrations Installation Requirements

"For penetrations in the building envelope such as hose bibs and holes 1 1/2" diameter or larger, such as dryer vents, a block of HardieTrim® 5/4, 4/4 boards should be installed around the point of penetration. To install a block around an existing vent pipe, it may be necessary to cut the block into two pieces. In this case, weather-cut the trim to fit into place. Install flashing over top of the trim block."

James Hardie - Best Practices - Installation Guide Version 3.1
General Installation Requirements - Page 18 (HZ5) Page 17 (HZ10)

SturdiBuild®

1003 Forsyth Ave. Indian Trail, NC 28079
Phone: 704.882.0777 Fax: 704.882.0775

The recommended by James Hardie and ColorPlus trademarks and logos are trademarks or registered trademarks of James Hardie International Finance B.V. in the U.S. and other countries.

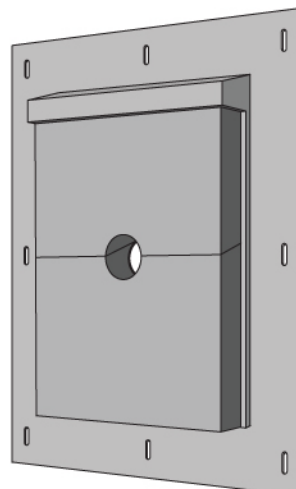

Step 2 - Feed water spigot or other application through the rectangular flange hole. Slide bottom half of block back up until tight. Face nail with 2" brad nails. Do not caulk 22.5° weathercut edge.