

Figure 1

STEP 1: Excavate the area to the adequate depth for the window well and extension. Once the areaway has been excavated, install the standard window well on the foundation per the instructions in the window well carton. The extension panels will be added after the standard window well is installed.

STEP 2: Once the window well is installed, align each extension side panel with the window well sides as shown in Figure 1 and attach them to the foundation using masonry anchors. Use (2) masonry anchors at the very top of each extension side panel and (1) at the very bottom. (Note: extension side panel mounting flanges may be repositioned to the inside if required, refer to STEP 2 of the installation instructions provided with the window well).

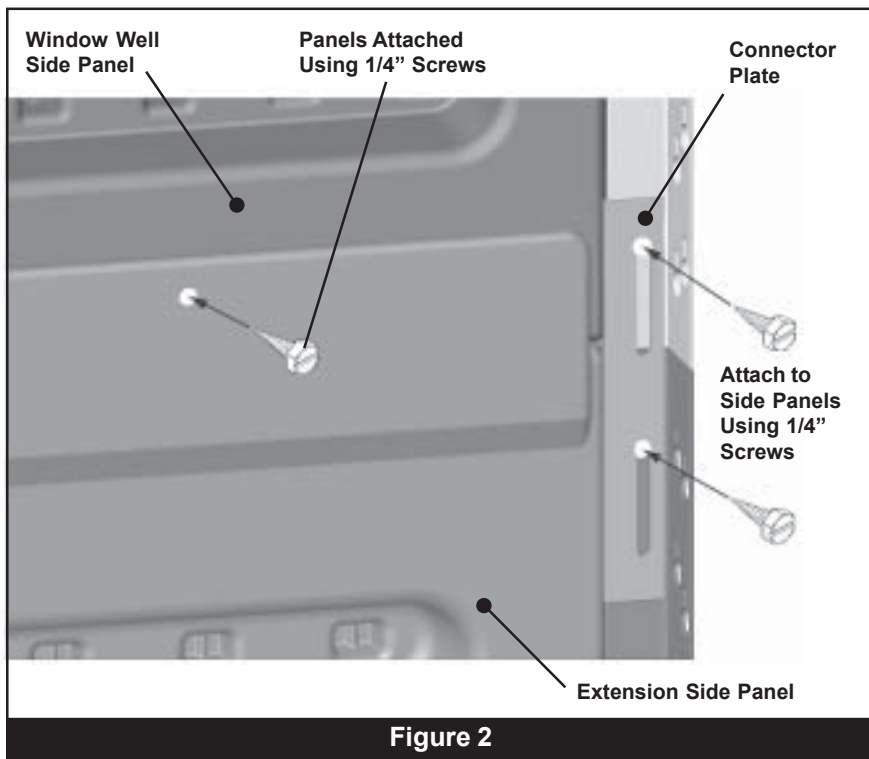

Figure 2

Attach extension side panels to window well side panels using the 1/4-20 x 1" screws provided, see Figure 2.

STEP 3: Attach connector plates to the side panels as shown in Figure 2 using the 1/4-20 x 1" screws provided.

STEP 4: Position the extension step panel as shown in Figure 1, snapping it into place. Cross-pin the step panel to each of the extension side panels at the pre-marked location using nails per STEP 4 and FIGURE 4 of the installation instructions provided with the window well.

STEP 5: Backfill the area per STEP 6 of the of the installation instructions provided with the window well.

Installation Questions ?

Call 1-800-854-9724

Monday - Friday

8:15 A.M. - 5:00 P.M. E.S.T.

or log on to www.bilco.com



Building on Our Tradition™